

SUBMITTAL DATA SHEET

JOB NAME: _____ DATE: _____
 LOCATION: _____
 ENGINEER: _____
 WHOLESALER: _____
 CONTRACTOR: _____
 SUBMITTED TO: _____
 MODEL DESIGNATION: _____ FUEL: _____



CHECK ONE: _____ REFERENCE (NOT FOR PRODUCTION)
 _____ APPROVED (IMMEDIATE PRODUCTION)
 _____ APPROVED WITH CHANGES NOTED (IMMEDIATE PRODUCTION)

RATINGS AND TECHNICAL DATA							
EVOLUTION EVO MODELS	INPUT (MBH)	GROSS	THERMAL	HEATING	WATER	*FUEL	SHIPPING
		OUTPUT (MBH)	EFFICIENCY (%)	SURFACE (SQ/FT)	CONTENT (GAL.)	NAT. GAS / LP Gas MIN / MAX	WEIGHT (LBS)
EVO-500	500	431	86.2%	123	6.1	5"-14" wc	772
EVO-750	750	638	85.1%	131	15.9	7"-14" wc	1097
EVO-1000	1000	850	85.0%	175	16.4	7"-14" wc	1185
EVO-1500	1500	1275	85.0%	264	17.4	7"-14" wc	1327
EVO-2000	2000	1696	84.8%	352	18.5	7"-14" wc	1461

* Please refer to PRODUCT UPDATE issued June 6, 2024. This data supersedes data found on Table 3 of I&O Manual.

DIMENSIONS

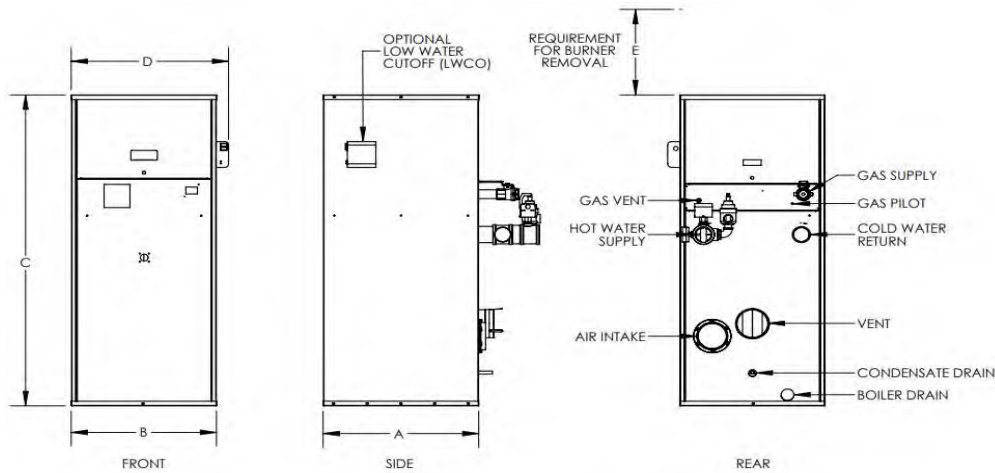

EVOLUTION EVO MODELS	"A"	"B"	"C"	"D"	"E"	VENT / AIR INTAKE		GAS	SUPPLY	RETURN
	LENGTH	WIDTH	HEIGHT	WIDTH	BURNER REMOVAL	VENT	AIR INTAKE		OUTLET	INLET
	(Inches)	(Inches)	(Inches)	(w/ LWCO)		(Inches)	(Inches)	(Inches)	(Inches)	NPT Male
EVO-500	30 3/8	28 3/8	71 1/4	31	16	4	4	1	2	2
EVO-750	30 3/8	28 3/8	60 15/16	31	16	4	6	1	3	3
EVO-1000	30 3/8	28 3/8	67 3/8	31	16	6	6	1 1/2	3	3
EVO-1500	30 3/8	28 3/8	79 7/16	31	19	6	8	1 1/2	3	3
EVO-2000	30 3/8	28 3/8	91 7/8	31	31	6	8	1 1/2	3	3

* Features Double Row of Copper Fin Tubes!

SUBMITTAL DATA SHEET

STANDARD EQUIPMENT

PRESSURE VESSEL DESIGN

Copper Fin-tube construction
Carbon steel or cast iron header design
Gasketless heat exchanger
ASME Section IV certified "H" stamp
MAWP 160 PSI & max design temp 250°F
5-year heat exchanger warranty
20-year thermal shock warranty

COMBUSTION DESIGN

Maintenance-free ceramic burner
Ultr-low NOx emissions (<10ppm)
Whisper quiet operation (<50 dBA)
Industrial-grade combustion air filter, 99% efficient
Industrial cast aluminum blower assembly
Variable frequency drive
Electric spark-to-pilot ignition system
10-year burner warranty
Robust UV-Scanner

VENTING

Sealed or room air combustion
Direct vent (sidewall or vertical) (Cat IV)
Conventional venting (Cat II)
NOTE: This is NOT a Cat 1 Vent appliance.

BOILER EQUIPMENT

Siemens RWF55 operating control
High limit w/ manual reset safety temperature control
Water flow switch
Low water cut-off with manual reset safety controller
Outlet temperature sensor
Combustion air switch
Pressure and temperature gauge
Safety relief valve (optional pressures 30-150 PSI)
Single point electrical supply (Available in 1 or 3 phase; See below for details).

BURNER EQUIPMENT

UL/FM/CSD-1 gas train
Reliable Turndown
Natural or LP gas
Pilot gas valve / Pilot gas regulator
Siemens SKP-75 gas valve
Low and high gas pressure switches with manual reset

SIEMENS RWF55 OPERATING CONTROL FEATURES

Adjustable set point
Remote set point (0-10v or 4-20 mA)
Outdoor air temperature reset
Remote system temperature monitoring

OPTIONAL EQUIPMENT

Low gas pressure venturi, allows operation down to 4" wc (Available on Models 750-2000 Only)

Double block & bleed (DB&B) Gas Train - (1) motorized & (1) solenoid valve & N.O. vent valve

IRI with Proof of Closure Gas Train - (2) motorized valves w/ POC & N.O. vent valve

Honeywell 7800 Series display with ModBus Module

Line Reactor Adds voltage / spike protection for the blower's VFD. (*Highly recommended*.)

Electrical Power Supply:

120/60/1 (*Sizes 500-2000 ONLY*)

208/60/1

230/60/1

208/60/3

230/60/3

460/60/3

Safety Relief Valve Options:

30 PSI

50 PSI

60 PSI

75 PSI

100 PSI

125 PSI

150 PSI

Outdoor Air Sensor

Condensate neutralizer:

850 MBH

1,200 MBH

2,000 MBH

5,000 MBH

Hydronic Kit (Boiler Circulation Pump, Pump Flange Kit and Condensate Neutralizer) Sized based on a 20°F ΔT

Annual Maintenance Kit

Supply system temperature sensor

ModBus communication for Siemens RWF55 and Honeywell Flame Safeguard Control (Boiler to BMS System)

Universal communications gateway (BacNet MS/TP, BacNet/IP, LonWorks)

Local / remote switch

Alarm bell with silencing switch

Relays:

General Alarm

Boiler Status

Conductor Sequencing Panel: (Required for multiple EVA boiler applications without BMS); Contact Regional Manager with Questions.)

The Conductor manages multiple condensing & non-condensing, small & large heat output, new and/or existing boilers (full modulation or on-off), and steam or hot water applications. It helps improve system efficiency by selecting and modulating the right boiler to match operating conditions. The Conductor offers a single point boiler plant Energy Management System (EMS) interface including Modbus TCP/IP, Modbus RTU RS485, BACnet/IP and BACnet MSTP standard. If Lonworks needed, add for the separate Lonworks gateway.

Extended Warranty:

3 Year Parts

5 Year Parts

10-Year Parts

5-Yr. Prts/Lbr

10 Yr. Prts/Lbr